

# Stadt Barmstedt - Bauungsplan Nr. 83 - VORENTWURF

Blatt 2

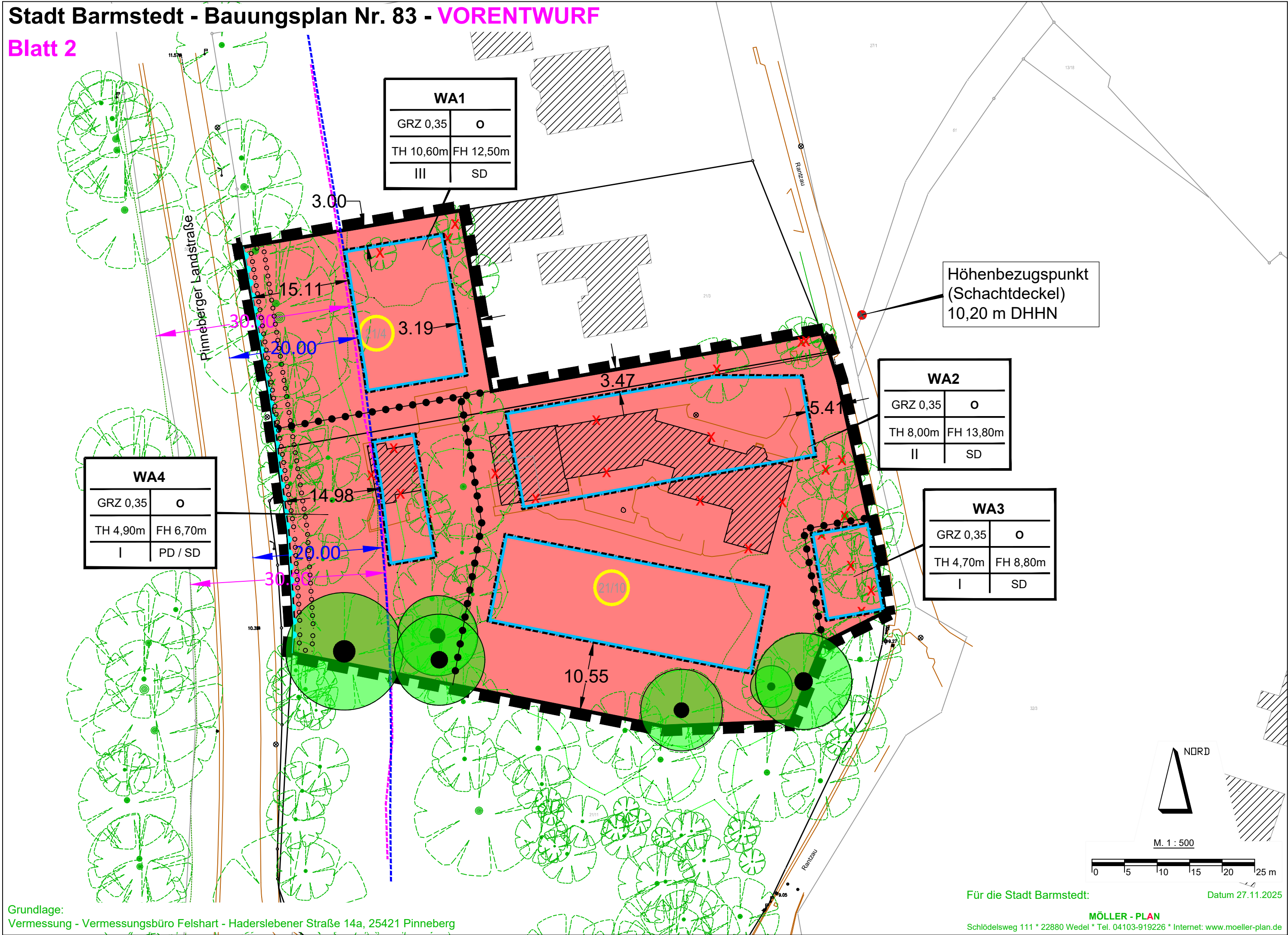

WA1	
GRZ 0,35	o
TH 10,60m	FH 12,50m
III	SD

Höhenbezugspunkt  
(Schachtdeckel)  
10,20 m DHHN

WA2	
GRZ 0,35	o
TH 8,00m	FH 13,80m
II	SD

WA4	
GRZ 0,35	o
TH 4,90m	FH 6,70m
I	PD / SD

WA3	
GRZ 0,35	o
TH 4,70m	FH 8,80m
I	SD



M. 1 : 500

